

EMFi BLDC HUB MOTOR

Model Number: EMF BL-12-36-250-250-SA

Technical Data Sheet

Product Description

EMFi proudly presents India's first spokes-type Hub Motor series. It is characterized by high torque and load carrying capacity. The motors have an IP54 rating, and IP67 rated models can be supplied on request. Custom power ranges are also available.

Our drive is easy to install in any spokes-type two- and three-wheeler vehicle. The motor is incorporated with a chain sprocket, and different sizes of spokes can be fitted to suit the road conditions of the vehicles intended use. Our warranty options also deliver after sales services and enable overall customer satisfaction.

Product Features

- Rear wheel drive
- Low speed Motors support up to 20 km/h*
- Nominal output up to 250 W*
- 9.6 Nm nominal and 52 Nm peak torque
- Weight: 9 kg
- No gear, no brush, no wear, no noise
- Smooth, controllable variable-speed operation
- Highly energy efficient

**Function and feature of Motor Controller*

Technical Drawings

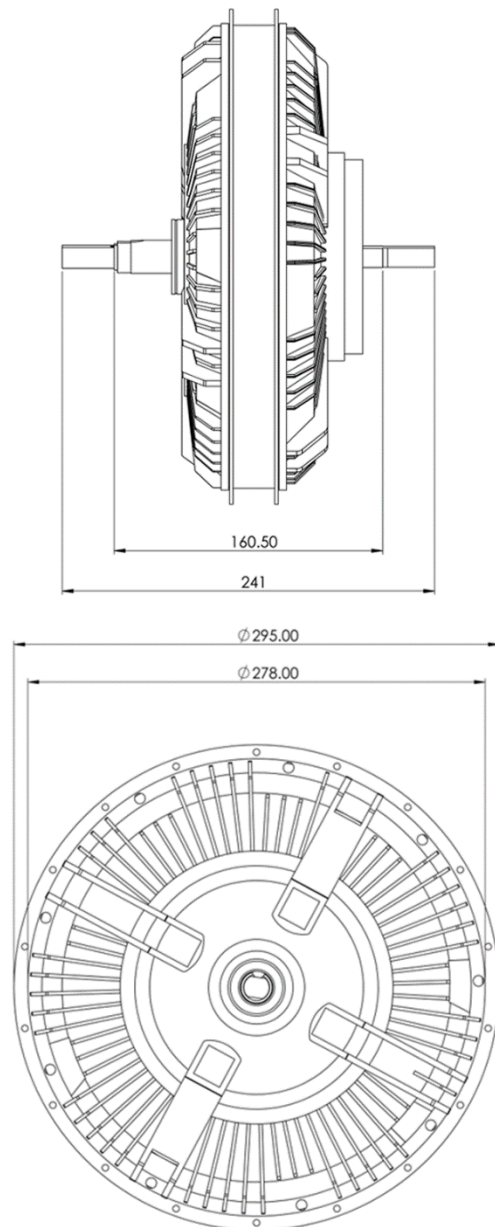

Motor Specifications

Motor Outer Diameter: 295mm
 Shaft Length: 241mm
 Brake Size: 110mm
 Brake Type: Regular Brakes (shoe type)
 Tyre Types: Tube

**Output Power (W)
vs Torque (N.m)**

Output Power (W)

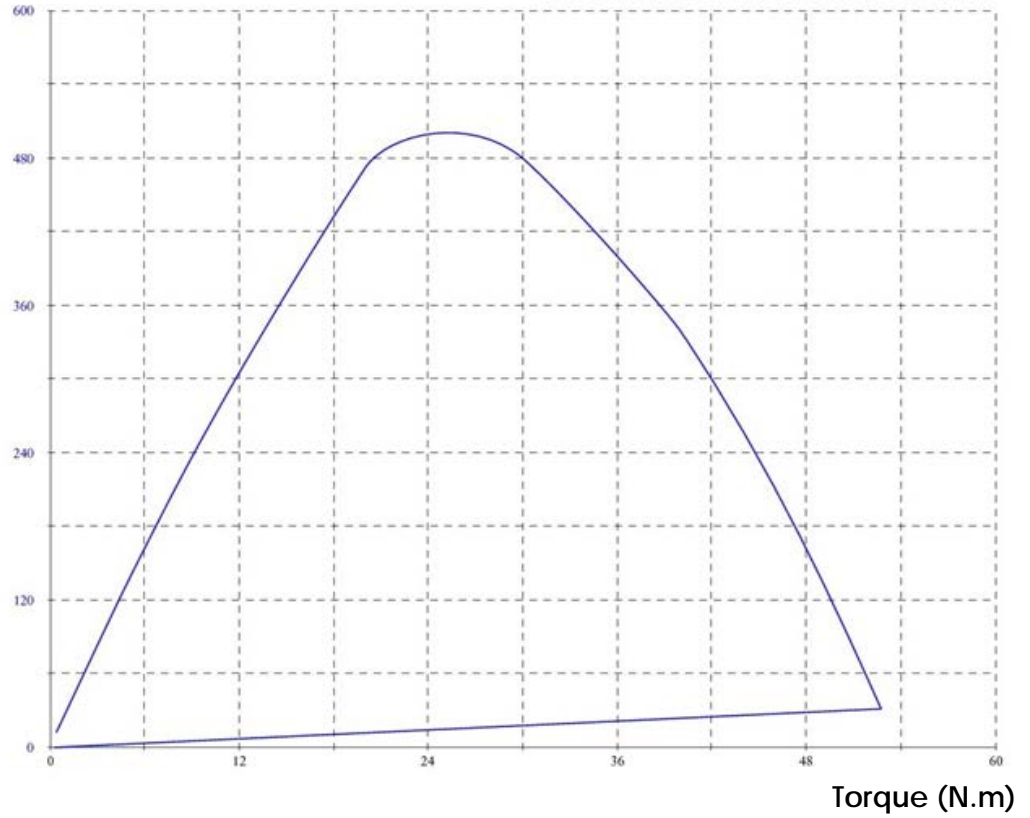

**Current (A)
vs Torque (N.m)**

Current (A)

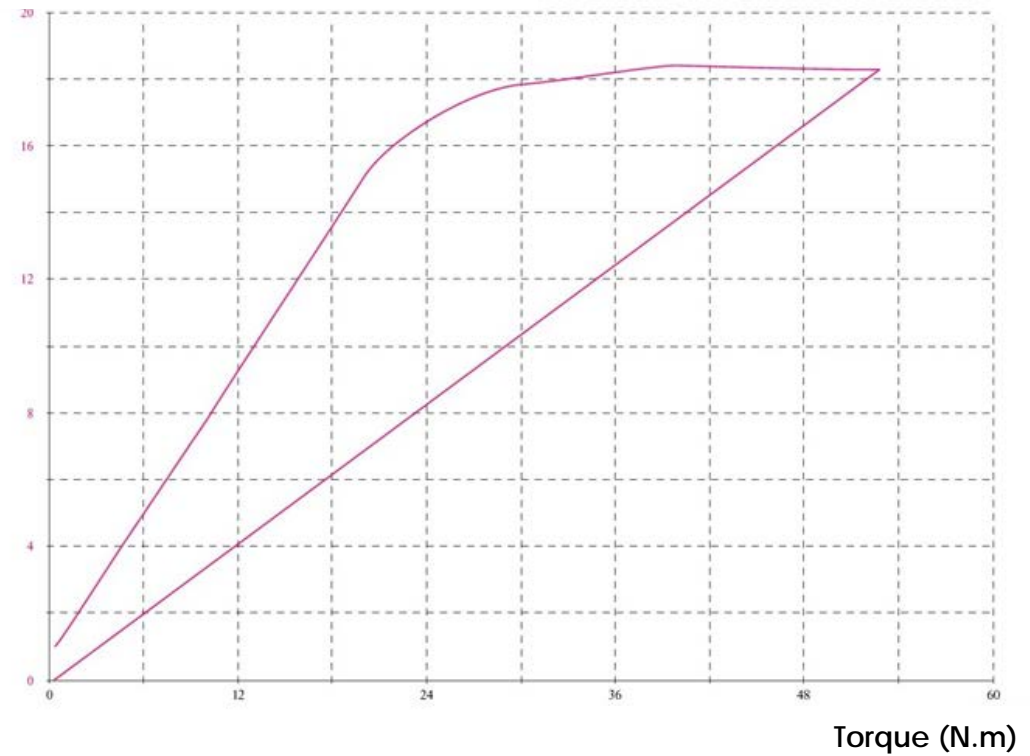

Speed (rpm)
vs Torque (N.m)

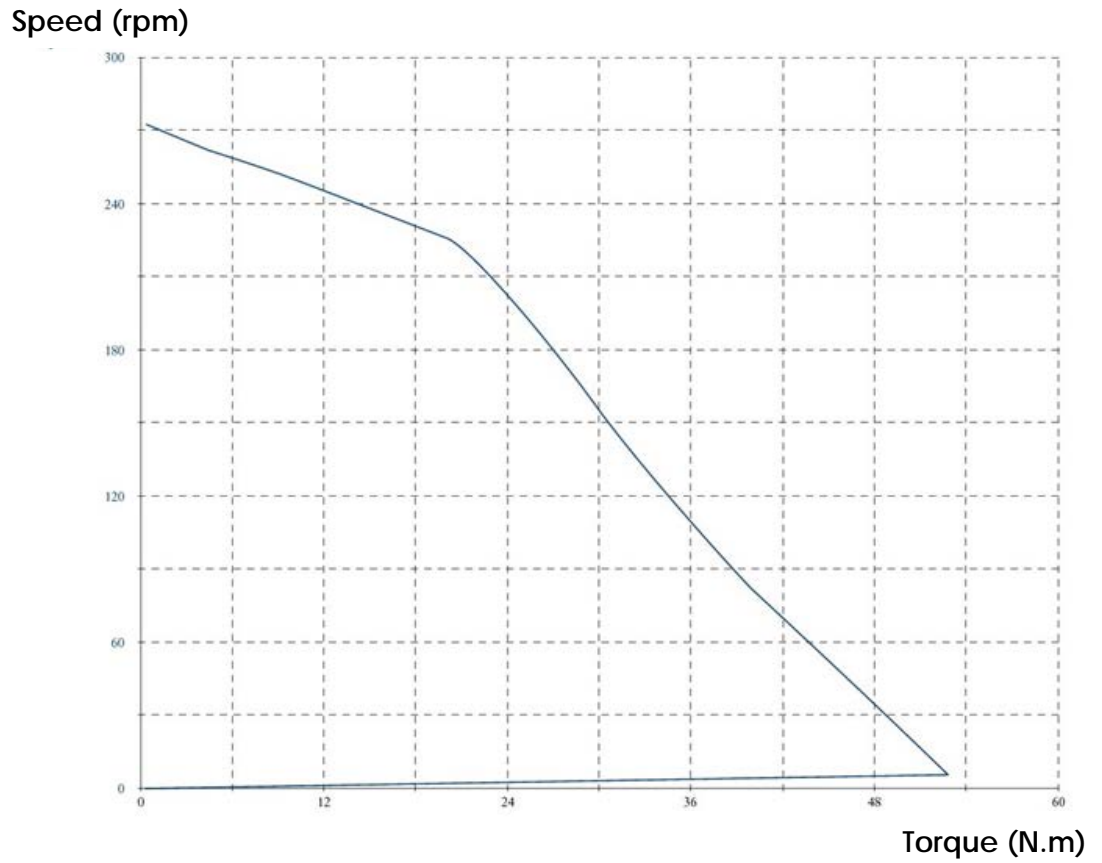

Efficiency (%)
vs Torque (N.m)

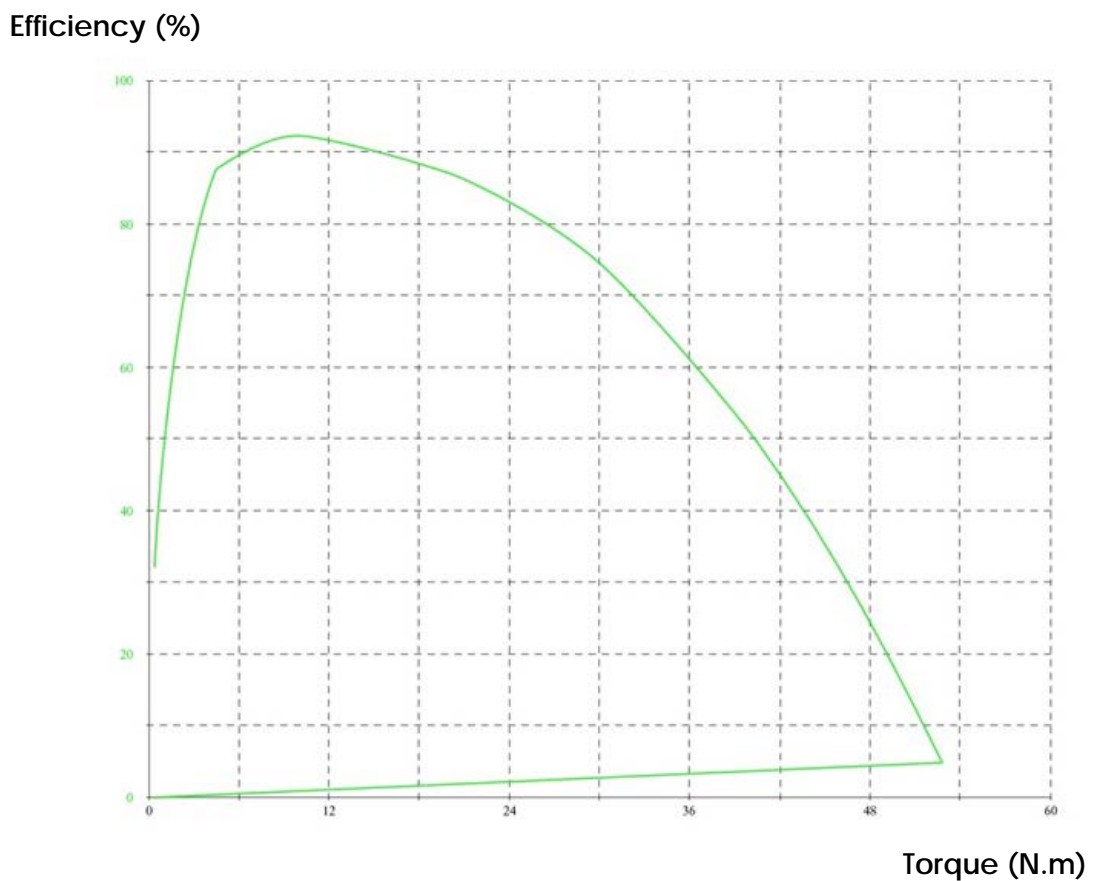

Input Power (W)
vs Torque (N.m)

Input Power (W)

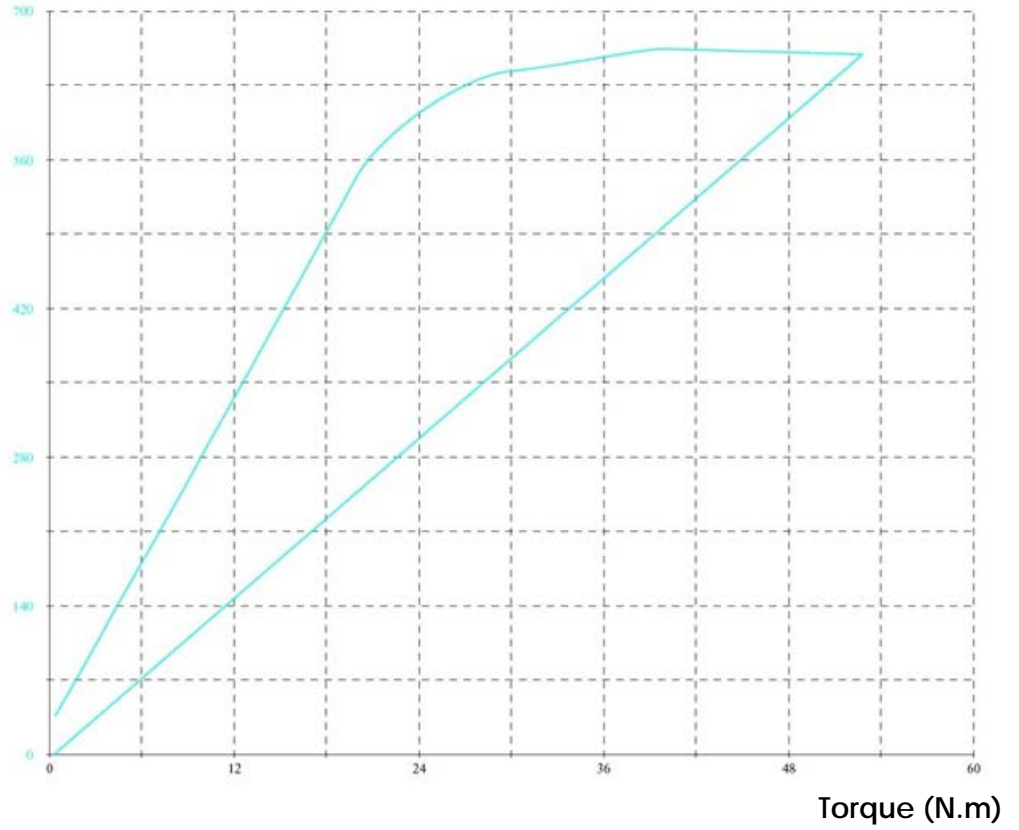

Technical Data

	Voltage (V)	Current (A)	Input Power (W)	Torque (N.m)	Speed (rpm)	Output Power (W)	Efficiency (%)	Time (s)
1	36.105	1.0125	36.556	0.4	272.4	11.730	32.1	0.0000
2	36.101	1.1644	42.034	0.7	271.9	18.925	45.0	2.9840
3	36.072	2.1631	78.029	2.1	267.9	58.941	75.5	5.9840
4	36.011	3.9130	140.91	4.5	261.6	123.48	87.6	8.9840
5	36.111	6.2894	227.12	7.9	254.6	210.08	92.5	12.000
6	36.107	7.5084	271.11	9.6	250.7	250.00	92.3	13.332
7	36.106	7.7992	281.60	10.0	249.8	259.52	92.2	13.650
8	36.103	9.0353	326.20	11.7	245.8	300.00	92.0	15.000
9	36.113	12.348	445.93	16.3	234.6	399.62	89.6	17.984
10	36.112	15.061	543.89	20.0	225.8	471.86	87.0	20.130
11	36.111	16.161	583.60	21.5	222.3	501.14	85.9	21.000
12	36.112	17.707	639.45	26.8	183.0	514.16	80.4	23.984
13	36.111	17.822	643.60	30.0	155.2	479.11	74.5	25.558
14	36.111	17.927	647.37	32.9	130.0	447.34	69.1	26.984
15	36.110	18.415	664.97	39.0	87.6	357.73	53.8	29.984
16	36.110	18.401	664.46	40.0	81.8	338.83	51.0	30.413
17	36.111	18.316	661.43	46.0	46.9	225.42	34.1	32.984
18	36.110	18.281	660.14	50.0	22.5	110.86	16.8	34.749
19	36.110	18.256	659.23	52.8	5.5	30.664	4.7	35.984
20	36.171	0.0000	0.0000	0.3	0.0	0.0000	0.0	39.000

Specifications

Rated Power (Watts)	250
Rated Torque (N.m)	9.6
Peak Torque (N.m)	52
Operating Voltage (Volts)	36
Rated Current (A)	7.5
Peak Current (A)	18
Rated RPM	250

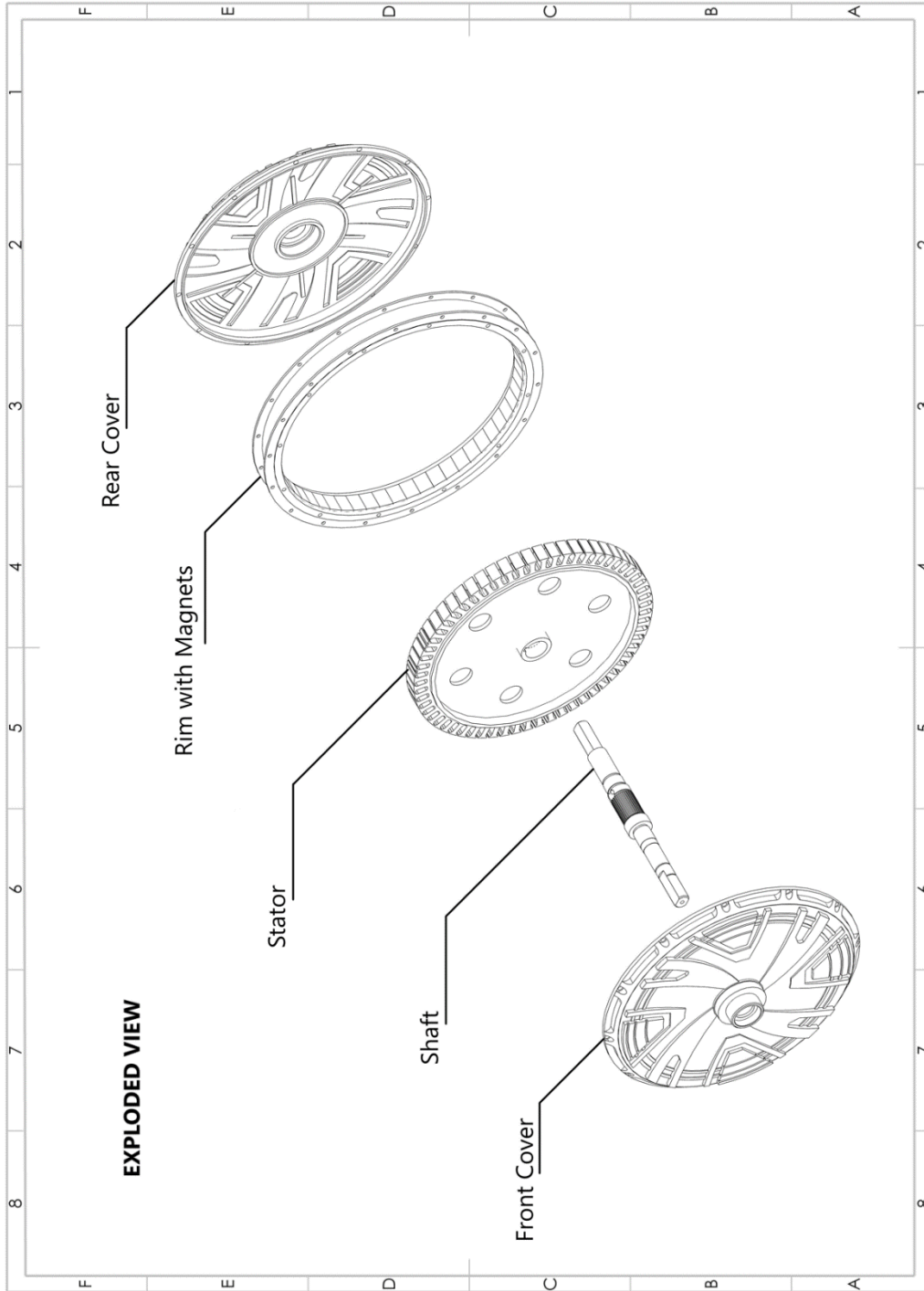



Do write in to us if you would like to request for
motor samples or a factory tour.

EMF INNOVATIONS PVT LTD

Corporate HQ

52/2A Shanmuga Nagar,
Sungam ByePass Road,
Coimbatore – 641045

Manufacturing Site

2/209, Rajiv Gandhi Nagar
Mylampatti Village, Neelambur
Coimbatore – 641062

Contact Information

Website: emf-i.com
Email: contactus@emf-i.com
Telephone: +91 82203 89111 / +91 98949 04486